

# Suggested Sensor Selection

## Sensor Junction Box Mold mounted

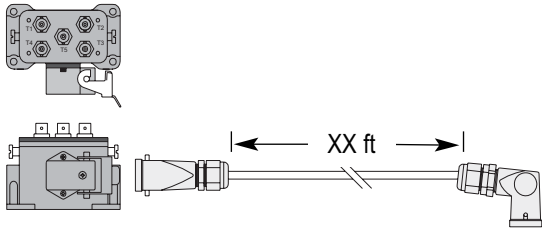

SJB-B-5 .....	\$ 228.00
SCA-6-FM-16 .....	\$ 89.00
SCA-6-FM-32 .....	\$ 102.00

## Sensor Junction Box Machine mounted

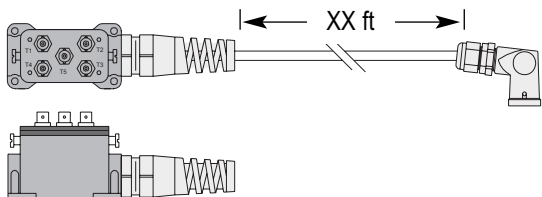

SJB-B-5-16 .....	\$ 312.00
SJB-B-5-32 .....	\$ 325.00

## Machine Cycle Switch Ass'y MCS-R-M16

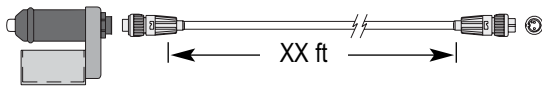

MCS-R-M .....	\$ 288.00
CMM-2-16 .....	\$ 62.00

## Alarm Output Cable

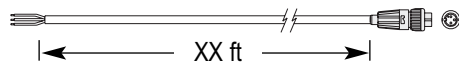

CMS-3-16 .....	\$ 58.00
----------------	----------

### Sensor Choice:

- 1st choice: - Adjacent to part surface
- 2nd choice: - Adjacent runner surface
- 3rd choice: - Adjacent sprue surface
- 4th choice: - Internal Wet Probe
- 5th choice: - External Wet Probe
- 6th choice: - Magnetic Disc Probe

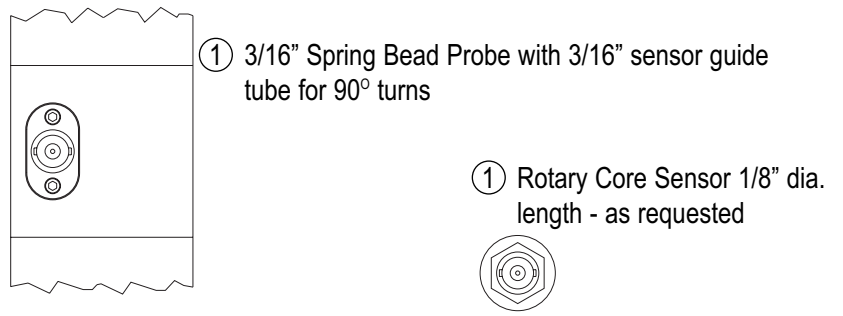

① Rotary Core Sensor 1/8" dia. length - as requested

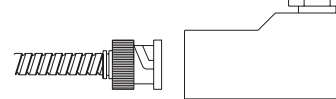
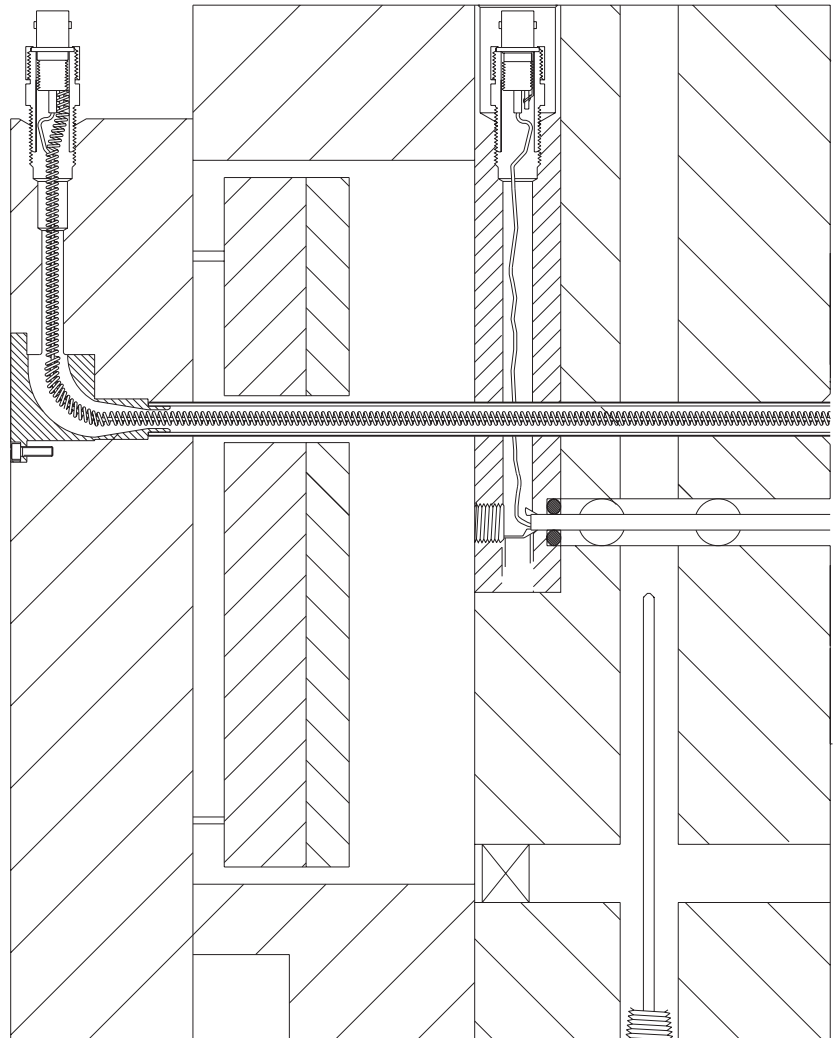

④ Internal Wet Probe Type "P"

Use with "Pulse Advance" Controller

For Sensor position and distance from part, see Sensor Installation Instruction.

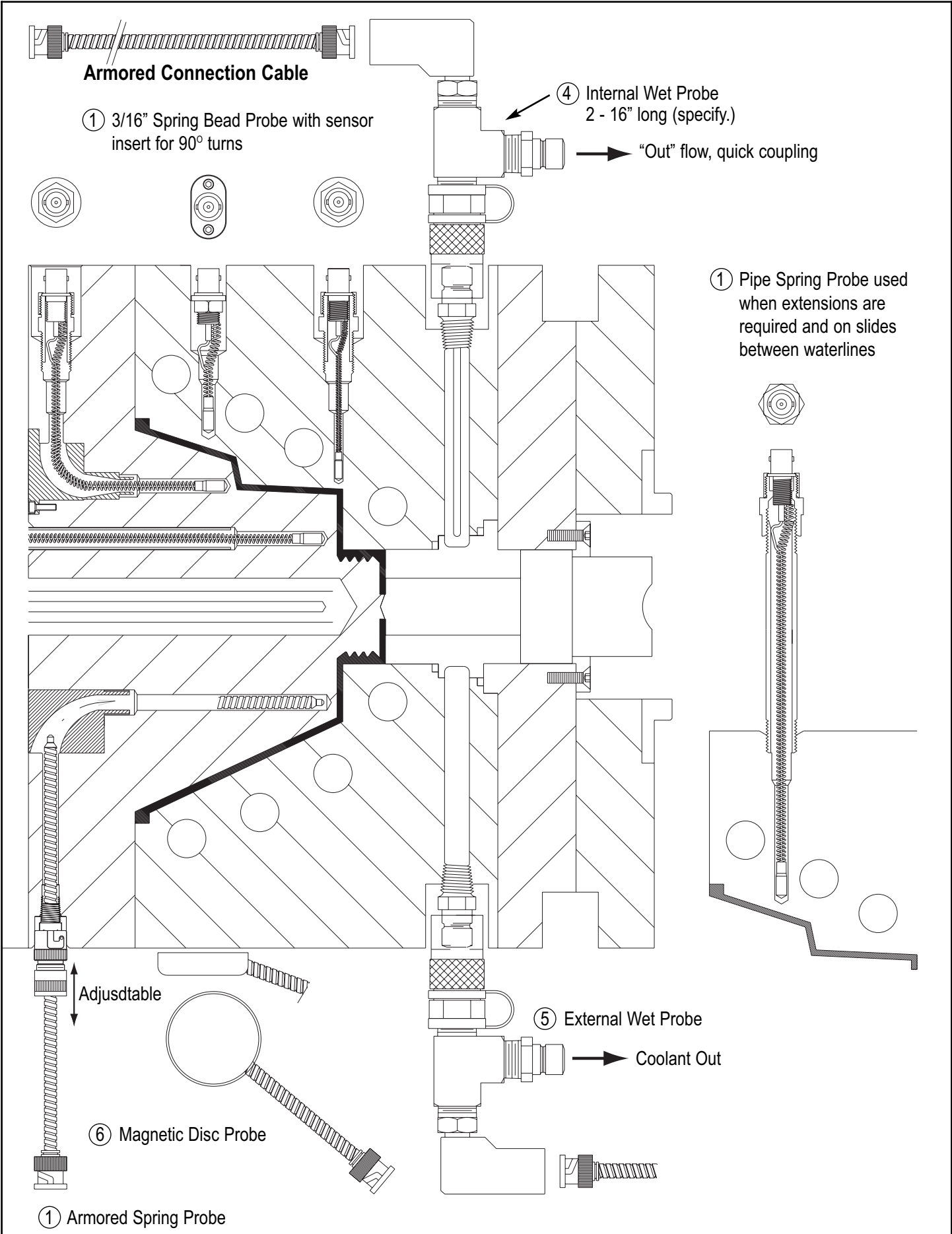

# Armored Spring Probes

**1/8" Armored Spring Probe, 1/8" X .5" Long Tip** Installation instructions - see MM-1410

MFG.DWG. MM-1206

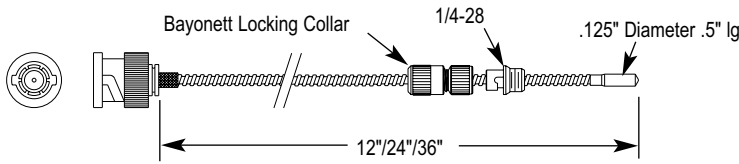

Custom sizes call for Quote

To make a 90° change in direction use  
sensorguide insert SGI-8-1500-2

BODY DIAMETER	CABLE LENGTH	PART NO.	PRICE
1/8"	12"	ASP-B-2-20-12 . . .	\$ 88.00
1/8"	24"	ASP-B-2-20-24 . . .	\$ 92.00
1/8"	36"	ASP-B-2-20-36 . . .	\$104.00

**1/4" Armored Spring Probe, 1/8" X .3" Long Tip** Installation instructions - see MM-1620 and MM-1622

MFG.DWG. MM-1208

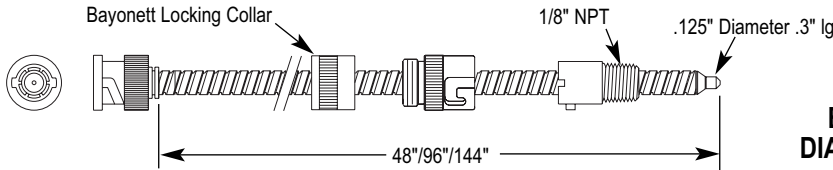

Custom sizes call for Quote

To make a 90° change in direction use  
sensorguide insert SGI-8-1500-2

BODY DIAMETER	CABLE LENGTH	PART NO.	PRICE
1/4"	48"	ASP-B-8-20-48 . . .	\$ 88.00
1/4"	96"	ASP-B-8-20-96 . . .	\$ 96.00
1/4"	144"	ASP-B-8-20-144 . . .	\$104.00

**1/4" Armored Spring Probe, 1/8" X 1" Long Tip** Installation instructions - see MM-1610

MFG.DWG. MM-1212

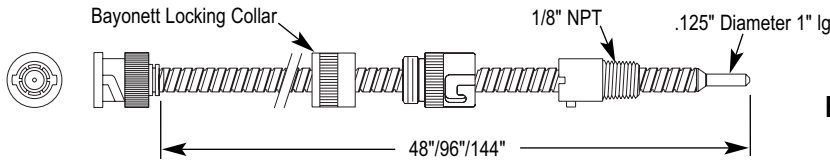

Custom sizes call for Quote

**NOTE: Do not use with  
Sensor Guide Insert**

BODY DIA.	TIP DIA.	CABLE LENGTH	PART NO.	PRICE
1/4"	1/8"	48"	ASP-B-4-20-48 . . .	\$ 88.00
1/4"	1/8"	96"	ASP-B-4-20-96 . . .	\$ 96.00
1/4"	1/8"	144"	ASP-B-4-20-144 . . .	\$104.00

**Spring Probe Reducer 1/8" NPT 1/4-28**

MFG.DWG. MM-8008

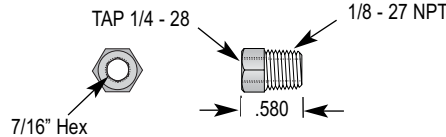

BODY DIAMETER	PART NO.	PRICE
1/8"	SPR-4-2-N . . . . .	\$ 2.80

**1/4" Armored Spring Probe (BNC) "T" Type** Installation instructions - see MM-1630

MFG.DWG. MM-1249

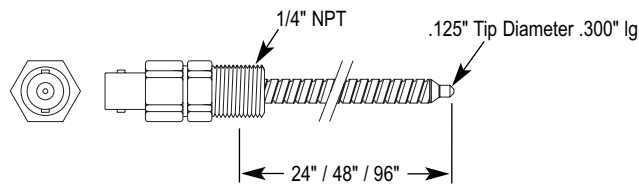

Use BNC Connection Cable

THREAD DIAMETER	CABLE LENGTH	PART NO.	PRICE
1/4"	24"	ASP-T-8-20-24 . . . . .	\$ 88.00
1/4"	48"	ASP-T-8-20-48 . . . . .	\$ 90.00
1/4"	96"	ASP-T-8-20-96 . . . . .	\$ 94.00

## Magnetic Disc Sensor

MFG.DWG. MM-1290

**Magnetic Disc Sensor (BNC) Type** Installation instructions - see MM-1818-B

CABLE LENGTH	PART NO.	PRICE
72"	MM-B-36-20-72 . . .	\$ 96.00

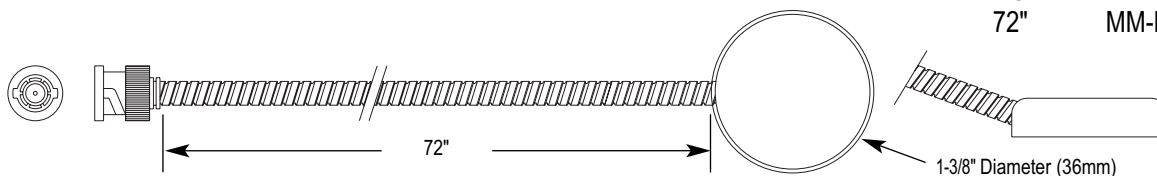

# Spring Bead Probes

**1/8" Spring Bead Probe (BNC) "B" Type** Installation instructions - see MM-1510 and MM-1522

MFG.DWG. MM-1240

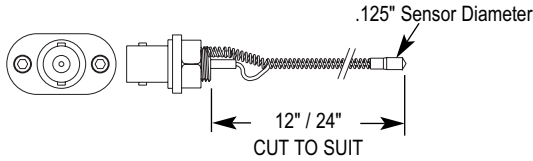

DIAMETER	LENGTH	PART NO.	PRICE
1/8"	12"	SBP-B-4-20-12 . . . .	\$ 64.00
1/8"	24"	SBP-B-4-20-24 . . . .	\$ 68.00

Use with type "BB" Extension Cable

**3/16" Spring Bead Probe (BNC) "B" Type** Installation instructions - see MM-1520 and MM-1522

MFG.DWG. MM-1242

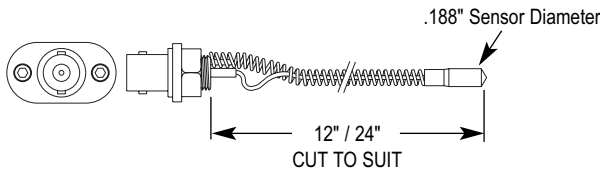

DIAMETER	LENGTH	PART NO.	PRICE
3/16"	12"	SBP-B-6-20-12 . . . .	\$ 68.00
3/16"	24"	SBP-B-6-20-24 . . . .	\$ 72.00

Use with type "BB" Extension Cable

**1/8" Spring Bead Probe (BNC) Type "T" 1/4" NPT** Installation Instructions - see MM-1710 and MM-1722

MFG.DWG. MM-1244

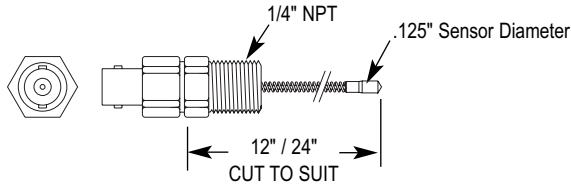

DIAMETER	LENGTH	PART NO.	PRICE
1/8"	12"	SBP-T-4-20-12 . . . .	\$ 66.00
1/8"	24"	SBP-T-4-20-24 . . . .	\$ 68.00

Use with type "BB" Extension Cable

**3/16" Spring Bead Probe (BNC) Type "T" 1/4" NPT** Installation Instructions - see MM-1720 and 1722

MFG.DWG. MM-1246

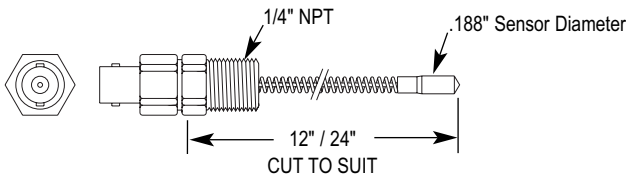

DIAMETER	LENGTH	PART NO.	PRICE
3/16"	12"	SBP-T-6-20-12 . . . .	\$ 66.00
3/16"	24"	SBP-T-6-20-24 . . . .	\$ 70.00

Use with type "BB" Extension Cable

**3/16" Pipe Spring Bead Probe (BNC) Type "P" 1/4" NPT** Installation Instructions - see MM-1720 and 1722

MFG.DWG. MM-1248

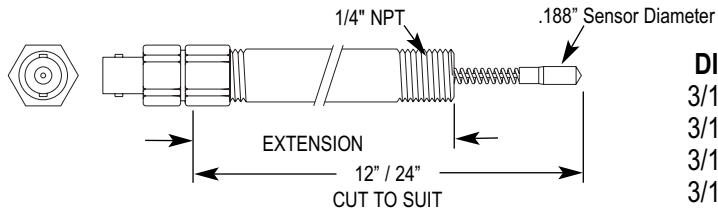

DIAMETER	SENSOR EXTENSION	LENGTH	PART NO.	PRICE
3/16"	4"	12"	SBP-P4-6-20-12 . . .	\$ 68.00
3/16"	6"	12"	SBP-P6-6-20-12 . . .	\$ 70.00
3/16"	8"	24"	SBP-P8-6-20-24 . . .	\$ 77.00
3/16"	10"	24"	SBP-P10-6-20-24 . . .	\$ 74.00

Use with type "BB" Extension Cable

## Connection Cables

MFG.DWG. MM-1268

**Armored Connection Cable - BB**

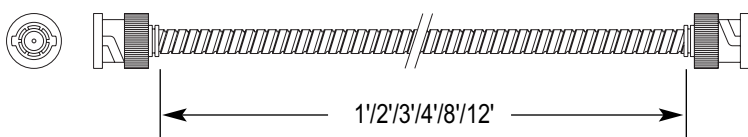

CABLE LENGTH	PART NO.	PRICE
1'	ACC-BB-012 . . . .	\$ 58.00
2'	ACC-BB-024 . . . .	\$ 68.00
3'	ACC-BB-036 . . . .	\$ 78.00
4'	ACC-BB-048 . . . .	\$ 88.00
8'	ACC-BB-096 . . . .	\$ 102.00
12'	ACC-BB-144 . . . .	\$ 124.00

# Liquid Temperature Sensors

**Internal Wet Probe Type "P"** (for sensing inside cross channel waterline) Installation instructions See MM-1840 and MM-1818-B

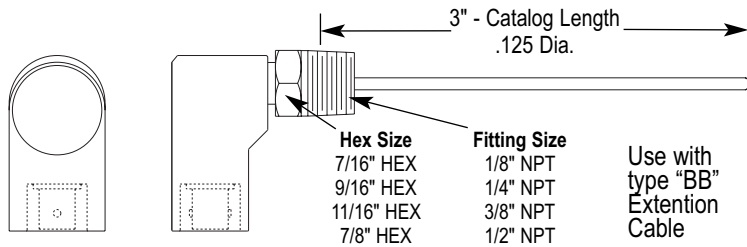

MFG.DWG. MM-1316

PROBE LENGTH (XX)	FITTING SIZE (X)	PART NO.	PRICE
3" = 03	1/8" = 1	IWP-4-20-XX-1 . . . .	\$ 130.00
6" = 06	1/4" = 2	IWP-4-20-XX-2 . . . .	\$ 138.00
9" = 09	3/8" = 3	IWP-4-20-XX-3 . . . .	\$ 144.00
12" = 12	1/2" = 4	IWP-4-20-XX-4 . . . .	\$ 150.00
15" = 15			
18" = 18			

Base price + \$2.00 per inch of probe length

**Internal Wet Probe Type "F"** (for sensing inside of outgoing waterline) Installation instructions See MM-1840 and MM-1818-B

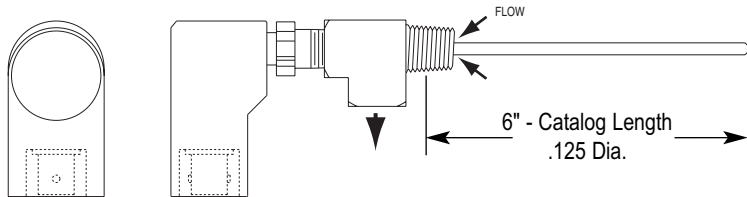

MFG.DWG. MM-1362

PROBE LENGTH (XX)	FITTING SIZE (X)	PART NO.	PRICE
3" = 03	1/8" = 1	IWF-4-20-XX-1 . . . .	\$ 132.00
6" = 06	1/4" = 2	IWF-4-20-XX-2 . . . .	\$ 140.00
9" = 09	3/8" = 3	IWF-4-20-XX-3 . . . .	\$ 148.00
12" = 12	1/2" = 4	IWF-4-20-XX-4 . . . .	\$ 156.00
15" = 15			
18" = 18			

Base price + \$2.00 per inch of probe length

**Internal Wet Probe Type "R"** (Removable) Installation instructions See MM-1840 and MM-1818-B

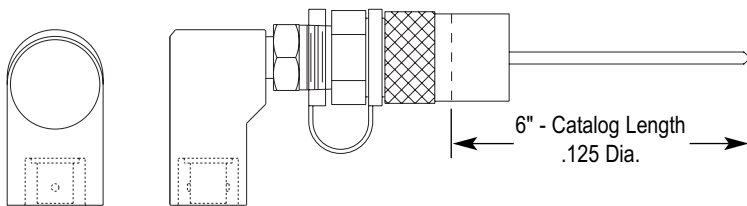

MFG.DWG. MM-1372

PROBE LENGTH (XX)	FITTING SIZE (X)	PART NO.	PRICE
3" = 03	1/8" = 1	IWR-4-20-XX-1 . . . .	\$ 142.00
6" = 06	1/4" = 2	IWR-4-20-XX-2 . . . .	\$ 148.00
9" = 09	3/8" = 3	IWR-4-20-XX-3 . . . .	\$ 154.00
12" = 12	1/2" = 4	IWR-4-20-XX-4 . . . .	\$ 160.00
15" = 15	3/4" = 6	IWR-4-20-XX-5 . . . .	\$ 166.00
18" = 18	1" = 8	IWR-4-20-XX-6 . . . .	\$ 172.00

Base price + \$2.00 per inch of probe length

**Internal Wet Probe Type "Q"** (for sensing inside of outgoing waterline) Installation instructions See MM-1840 and MM-1818-B

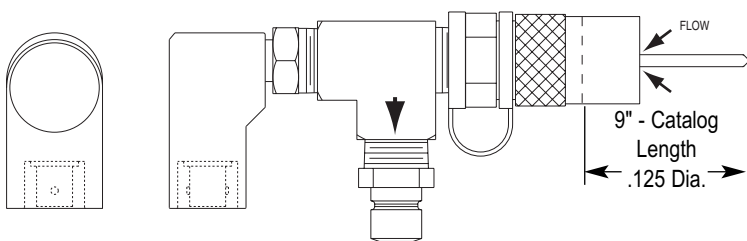

MFG.DWG. MM-1380

PROBE LENGTH (XX)	FITTING SIZE (X)	PART NO.	PRICE
3" = 03	1/8" = 1	IWQ-4-20-XX-1 . . . .	\$ 141.00
6" = 06	1/4" = 2	IWQ-4-20-XX-2 . . . .	\$ 147.00
9" = 09	3/8" = 3	IWQ-4-20-XX-3 . . . .	\$ 153.00
12" = 12	1/2" = 4	IWQ-4-20-XX-4 . . . .	\$ 169.00
15" = 15	3/4" = 6	IWQ-4-20-XX-5 . . . .	\$ 175.00
18" = 18	1" = 8	IWQ-4-20-XX-6 . . . .	\$ 181.00

Base price + \$2.00 per inch of probe length

**External Wet Probe Type "Q"** (for sensing inside of outgoing waterline) Installation instructions See MM-1820 and MM-1818-B

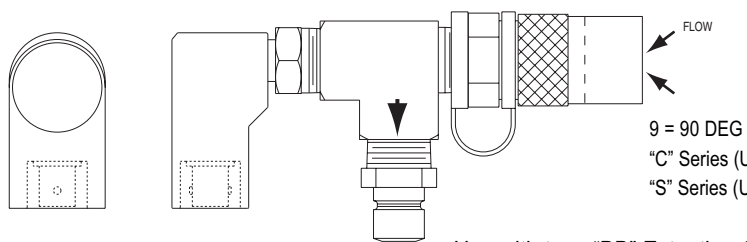

MFG.DWG. MM-1390

FITTING SIZE (X)	PART NO.	PRICE
1/8" = 1	EWQ-1-20-1-9C	\$ 125.00
1/4" = 2	EWQ-2-20-2-9C	\$ 138.00
3/8" = 3	EWQ-3-20-3-9C	\$ 145.00
1/2" = 4	EWQ-4-20-4-9C	\$ 153.00
3/4" = 6	EWQ-6-20-6-9S	\$ 161.00
1" = 8	EWQ-8-20-8-9S	\$ 172.00

**External Wet Probe Type "Q"** (for sensing inside of outgoing waterline) Installation instructions See MM-1820 and MM-1818-B

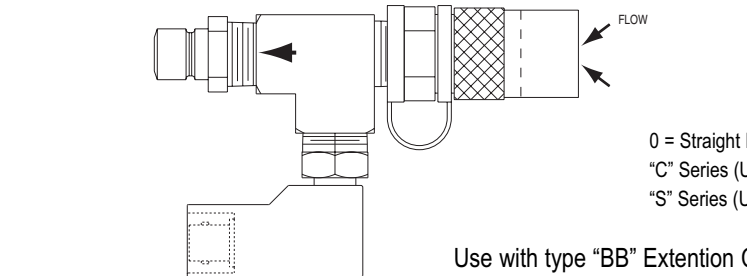

MFG.DWG. MM-1390

FITTING SIZE (X)	PART NO.	PRICE
1/8" = 1	EWQ-1-20-1-0C	\$ 125.00
1/4" = 2	EWQ-2-20-2-0C	\$ 138.00
3/8" = 3	EWQ-3-20-3-0C	\$ 145.00
1/2" = 4	EWQ-4-20-4-0C	\$ 153.00
3/4" = 6	EWQ-6-20-6-0S	\$ 161.00
1" = 8	EWQ-8-20-8-0S	\$ 172.00

# Sensor Guides

**3/16" Sensor Guide Insert** Instructions - see MM-1520/1522 (used with Spring Bead Probes only)

MFG.DWG. MM-8942

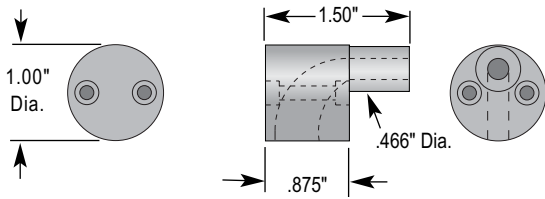

**PART NO.** SGI-6-875-1.5

**PRICE** \$ 26.00

**3/16" Sensor Guide Tube** Installation instructions - see MM-1720/1722 (used with Spring Bead Probes only)

MFG.DWG. MM-8944

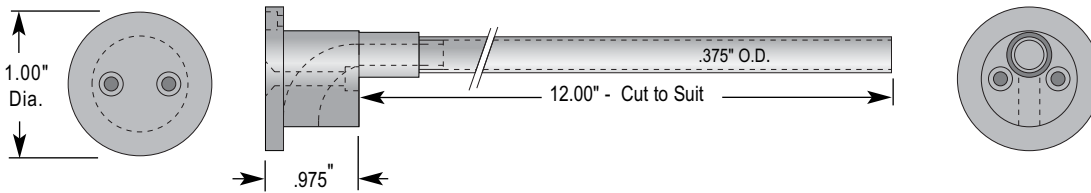

**PART NO.** SGT-6-875-12

**PRICE** \$ 46.00

**1/4" Sensor Guide Insert** Installation instructions - see MM-1620/1622 (used with Armored Spring Probe)

MFG.DWG. MM-8946

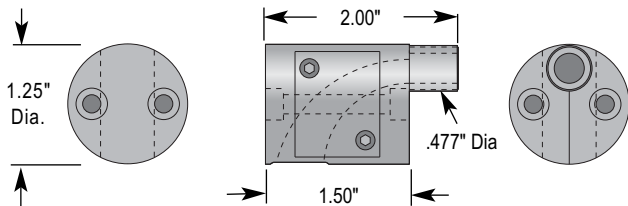

**PART NO.** SGI-8-1500-2

**PRICE** \$ 32.00

**1/4" Sensor Guide (Flat) Tube** Installation instructions - see MM-1620/1622 (used with Armored Spring Bead Probes)

MFG.DWG. MM-8952

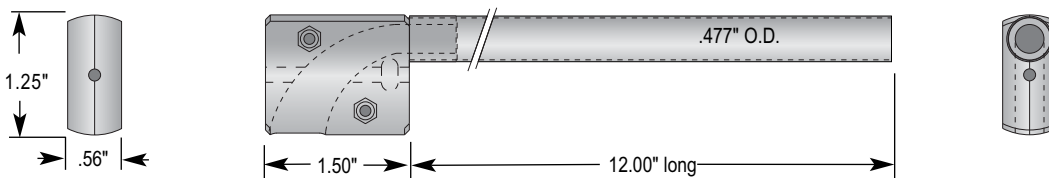

**PART NO.** SGF-8-1500-12

**PRICE** \$ 38.00

**1/4" Sensor Guide Tube** Installation instructions - see MM-1620/1622 (used with Armored Spring Probes only)

MFG.DWG. MM-8948

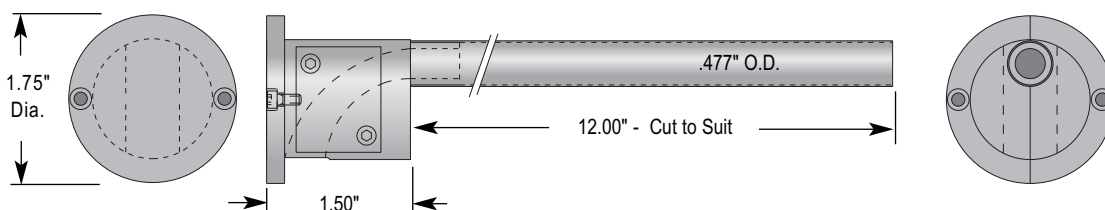

**PART NO.** SGT-8-1500-12

**PRICE** \$ 48.00